



blue photon®

Technology & Workholding Systems

Quick Start Guide

Pneumatic Dispenser with Dispenser Adapter Assembly

P/N 71906

Pneumatic adhesive dispensing unit with digital time/pressure display is compatible with BlueGrip™ workholding adhesives.

Features

- Digital time/pressure display
- Timed or steady modes of operation
- Vacuum control keeps thin fluids from dripping between cycles
- Dispenser adapter assembly (P/N 75880) required to operate dispenser
- Optional electric finger switch - use P/N 75490



P/N 43200



Unpack the unit.

Now is a good time to activate the warranty online at www.nordsonefd.com/warranty/dispensers/two.

1. NOTE: Clean, dry filtered air is required to meet warranty. If your air supply is not filtered, order the 5-micron filter/regulator. See the Dispenser Accessories data sheet at www.nordsonefd.com/DispenserAccessories for details.

Turn the air regulator adjustment knob to zero (0).

Connect one end of the air input hose to the Performus™; connect the other end to the plant air supply. Set the plant air supply between 5.5–7.0 bar (80–100 psi).

2. Attach the plug that matches the local power outlet to the power pack. Connect the power cord to the Performus and insert the plug into the local power source. Press the power button on the front panel.

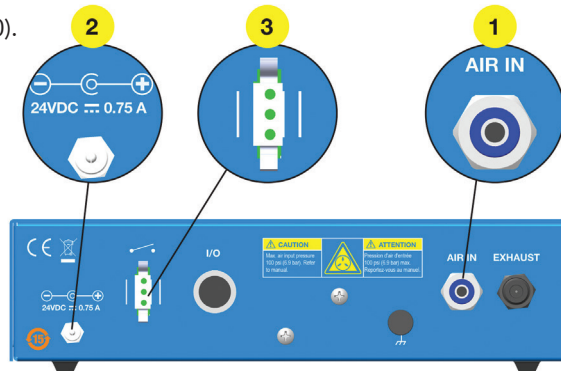

3. Connect the foot pedal or optional finger switch.
4. Attach a filled BlueGrip syringe barrel to the adapter assembly and snap the safety clip closed. Remove the tip cap, add a dispense tip (optional) if desired and place the syringe barrel in the barrel stand.
5. Insert the adapter assembly into the quick-connect fitting on the front of the Performus and twist to lock.
6. Set air pressure:
 - Pull the air regulator adjustment knob out to unlock it.
 - Turn the knob clockwise until the correct air pressure is shown on the LED display.
 - Push the air regulator adjustment knob in to lock it.

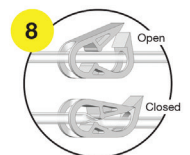

7. Set the dispense time (refer to the operating manual for detailed instructions):
 - Put the Performus in the Timed or Teach mode.
 - Use the Program/Teach function to set the dispense time.

8. Unsnap the safety clip on the adapter assembly.
9. Purge the dispense tip and apply fluid as described below:

- a. Put the dispenser in the Steady mode and press the foot pedal until fluid flows from the tip, then release the foot pedal.
- b. Put the dispenser in the Timed mode and press the foot pedal once to make a timed deposit.



www.BluePhotonGrip.com • 855-777-2040
1002 Industrial Park Dr., Shelby, MI 49455